



**MI Cable Technologies, Inc.**  
 Bay 5, 5905 - 11 Street SE, Calgary, Canada T2H 2A6  
**Tel:** 403-571-8266  
**Fax:** 403-571-8267  
**email:** sales@micabletechnologies.com

**Drawing # S-0101-01-04**

ISO9001:2015  
 ISO17025:2017

## Simplex (2-wire) Thermocouple Cable Design Specification, Double Wall

Sheath Types	Thermocouple Types	MgO Purity
310	T	Standard (> 97%)
316	E	High Purity (> 99.4%)
Inconel 600	J	
Inconel 601	K	
Incoloy 825	N	

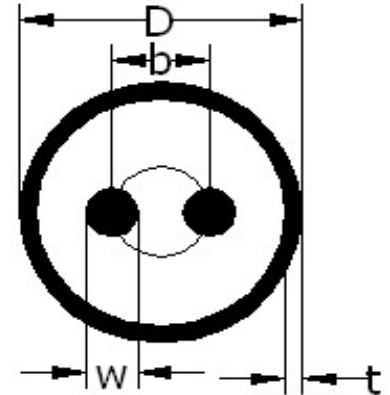

**Additional Options**  
 IEC Class 1 or Class 2, ASTM Standard or Special Limits of Error, AMS2750 (NADCAP), Cryogenic (T-type only)

**Coil diameter**  
 Cable of 0.375" (9.5mm) or less in diameter supplied in 24" diameter coils, otherwise supplied in 54" diameter coils

D Cable Diameter	t Sheath Thickness	b Bolt Circle Diameter	W Wire Diameter	Nominal Coil Length	IR Test Voltage	Dielectric Test Voltage
0.118" (3.0mm)	0.022" (0.57mm)	0.030" (0.76mm)	0.014" (0.36mm)	2246' (685m)	500V	500V
0.125" (3.2mm)	0.024" (0.60mm)	0.032" (0.80mm)	0.014" (0.36mm)	2002' (610m)	500V	500V
0.177" (4.5mm)	0.034" (0.85mm)	0.045" (1.14mm)	0.021" (0.53mm)	998' (304m)	500V	750V
0.188" (4.8mm)	0.036" (0.91mm)	0.048" (1.21mm)	0.022" (0.56mm)	885' (270m)	500V	750V
0.236" (6.0mm)	0.045" (1.14mm)	0.060" (1.52mm)	0.028" (0.71mm)	562' (171m)	500V	1000V
0.250" (6.4mm)	0.048" (1.21mm)	0.063" (1.61mm)	0.030" (0.76mm)	500' (152m)	500V	1000V
0.313" (8.0mm)	0.059" (1.51mm)	0.079" (2.02mm)	0.037" (0.94mm)	319' (97m)	500V	1000V
0.375" (9.5mm)	0.071" (1.81mm)	0.095" (2.42mm)	0.045" (1.14mm)	222' (68m)	500V	1000V
0.425" (10.8mm)	0.081" (2.05mm)	0.108" (2.74mm)	0.051" (1.30mm)	173' (53m)	500V	1000V
0.500" (12.7mm)	0.095" (2.41mm)	0.127" (3.22mm)	0.060" (1.52mm)	125' (38m)	500V	1000V

*Cable dimensions shown are nominal. Actual dimensions may vary within tolerance limits. Specifications subject to change without notice.*