

Drawing # S-0603-02-02

MI Cable Technologies, Inc.
 Bay 6, 5905 - 11 Street SE
 Calgary, Canada
 T2H 2A6

Tel: 403-571-8266

Fax: 403-571-8267

email: sales@micabletechnologies.com

28/09/2010

Eight Wire RTD Cable Design Specifications, C6 Series, Type Y Sheath

| | | | | | | | |
|---------------------------------|--------|--------------|--------------|--------------|--------------|--------------|--------------|
| Cable Diameter (D) | (inch) | 0.177 | 0.188 | 0.236 | 0.250 | 0.313 | 0.375 |
| | (mm) | 4.5 | 4.8 | 6.0 | 6.4 | 8.0 | 9.5 |
| Wire Diameter (W) | (inch) | 0.019 | 0.020 | 0.025 | 0.027 | 0.033 | 0.040 |
| | (mm) | 0.48 | 0.51 | 0.64 | 0.69 | 0.84 | 1.02 |
| Sheath Thickness (t) | (inch) | 0.020 | 0.021 | 0.027 | 0.029 | 0.036 | 0.043 |
| | (mm) | 0.51 | 0.53 | 0.69 | 0.74 | 0.91 | 1.09 |
| Bolt Circle Diameter (b) | (inch) | 0.089 | 0.094 | 0.119 | 0.126 | 0.158 | 0.189 |
| | (mm) | 2.26 | 2.39 | 3.02 | 3.20 | 4.01 | 4.80 |
| Coil Length | (feet) | 850 | 750 | 470 | 420 | 270 | 180 |
| | (m) | 259 | 229 | 143 | 128 | 82 | 55 |
| IR Test Voltage | VDC | 500 | 500 | 500 | 500 | 500 | 500 |
| Dielectric Test Voltage | VAC | 500 | 500 | 750 | 750 | 750 | 750 |

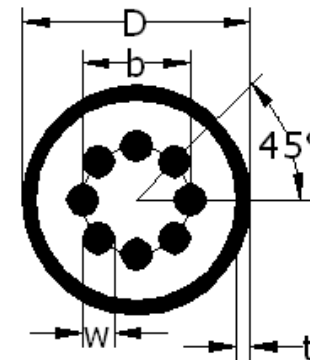

*Cable dimensions shown are nominal. Actual dimensions may vary within tolerance limits.
 Specifications subject to change without notice.*