

Drawing # S-0602-04-02

MI Cable Technologies, Inc.  
 Bay 6, 5905 - 11 Street SE  
 Calgary, Canada  
 T2H 2A6  
 Tel: 403-571-8266  
 Fax: 403-571-8267  
 email: sales@micabletechnologies.com

**Six Wire RTD Cable Design Specifications, Type Y Sheath**

<b>Cable Diameter (D)</b>	(inch)	<b>0.118</b>	<b>0.125</b>	<b>0.177</b>	<b>0.188</b>	<b>0.236</b>	<b>0.250</b>	<b>0.313</b>	<b>0.375</b>
	(mm)	<b>3.0</b>	<b>3.2</b>	<b>4.5</b>	<b>4.8</b>	<b>6.0</b>	<b>6.4</b>	<b>8.0</b>	<b>9.5</b>
<b>Wire Diameter (W)</b>	(inch)	0.013	0.014	0.020	0.021	0.026	0.028	0.035	0.042
	(mm)	0.33	0.36	0.51	0.53	0.66	0.71	0.89	1.07
<b>Sheath Thickness (t)</b>	(inch)	0.014	0.015	0.020	0.022	0.027	0.029	0.036	0.043
	(mm)	0.36	0.38	0.51	0.56	0.69	0.74	0.91	1.09
<b>Bolt Circle Diameter (b)</b>	(inch)	0.053	0.056	0.078	0.083	0.104	0.111	0.139	0.166
	(mm)	1.35	1.42	1.98	2.11	2.64	2.82	3.53	4.22
<b>Coil Length</b>	(feet)	1900	1700	850	750	470	420	270	180
	(m)	579	518	259	229	143	128	82	55
<b>IR Test Voltage</b>	VDC	500	500	500	500	500	500	500	500
<b>Dielectric Test Voltage</b>	VAC	500	500	500	500	750	750	750	750

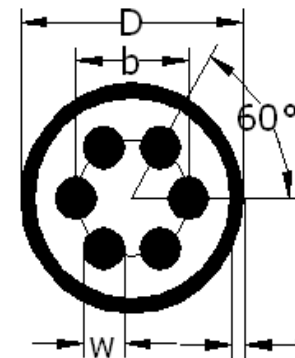

*Cable dimensions shown are nominal. Actual dimensions may vary within tolerance limits.  
 Specifications subject to change without notice.*