

Drawing # S-0601-01-02

MI Cable Technologies, Inc.
 Bay 6, 5905 - 11 Street SE
 Calgary, Canada
 T2H 2A6
 Tel: 403-571-8266
 Fax: 403-571-8267
 email: sales@micabletechnologies.com

28/09/2010

Four Wire RTD Cable Design Specifications, Standard Sheath

Cable Diameter (D)	(inch)	0.118	0.125	0.177	0.188	0.236	0.250	0.313	0.375
	(mm)	3.0	3.2	4.5	4.8	6.0	6.4	8.0	9.5
Wire Diameter (W)	(inch)	0.020	0.021	0.028	0.031	0.039	0.042	0.052	0.062
	(mm)	0.51	0.53	0.71	0.79	0.99	1.07	1.32	1.57
Sheath Thickness (t)	(inch)	0.010	0.011	0.015	0.016	0.020	0.021	0.027	0.032
	(mm)	0.25	0.28	0.38	0.41	0.51	0.53	0.69	0.81
Bolt Circle Diameter (b)	(inch)	0.048	0.051	0.072	0.076	0.095	0.101	0.127	0.152
	(mm)	1.22	1.30	1.83	1.93	2.41	2.57	3.23	3.86
Coil Length	(feet)	1900	1700	850	750	470	420	270	180
	(m)	579	518	259	229	143	128	82	55
IR Test Voltage	VDC	500	500	500	500	500	500	500	500
Dielectric Test Voltage	VAC	500	500	500	500	750	750	750	750

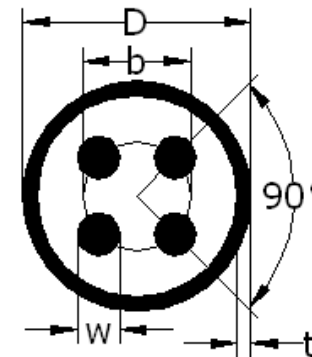

*Cable dimensions shown are nominal. Actual dimensions may vary within tolerance limits.
 Specifications subject to change without notice.*